

# CARBON COUNTY FAIR GUIDE



## CARBON COUNTY FAIR July 30-August 8

This special issue newsletter contains important information and instructions about County Fair. This does not replace the fair book! Make sure you **read the fair book carefully** to know all the rules and requirements of your particular class.

### TABLE OF CONTENTS

|                           |                       |
|---------------------------|-----------------------|
| 2 ~ Changes               | 12 ~ Rabbit / Poultry |
| 3 ~ Daily Self Check      | 13 ~ Horse            |
| 4 ~ Deadlines             | 14-15 ~ Goat / Sheep  |
| 5 ~ Animal Ownership      | 16-17 ~ Swine         |
| 6-8 ~ Schedule            | 17-18 ~ Beef          |
| 9-10 ~ Fabric and Fashion | 19-23 ~ Static        |
| 11 ~ Dog / Cat            |                       |

# CHANGES

## VOLUNTEERS!

We will need extra help this year! Please talk to your 4-H leader or Emily to see how you can help! We need help especially on Sunday, August 2, Static Judging Day and Friday, August 7, Buyer's Luncheon



Want to help?

Visit

<https://bit.ly/CarbonFairVolunteer> to volunteer for a job at

## Static

Static Judging on Sunday will be scheduled by last name this year to limit 50 people in the building at all times. Once FairEntry closes, static project members will be contacted about their judging time.



## Forms

Please be sure to print any forms in this guide that you may need during fair and bring them with you! We are trying to limit handling lots of paperwork & people coming in the front office



## PPE

Be sure to have your mask ready to use at all times and come with plenty of soap and hand sanitizer!



## Dance

Unfortunately, we will not be having a 4-H Dance this year. There was just no way we could make that a social distance event.



# DAILY SELF CHECK

# STOP

**WHILE AT FAIR, ASK YOURSELF THESE QUESTIONS EVERY MORNING & PLEASE STAY IN YOUR TRAILER OR CONSIDER GOING HOME IF YOU HAVE ANY OF THESE SYMPTOMS!**

- Fever
- Persistent Cough
- Sore Throat
- Tightness in Chest
- Shortness of Breath
- Headache/Dizziness
- Fatigue

**AS YOU PARTICIPATE PLEASE FOLLOW:**

- Social Distancing by 6ft
- Use hand sanitizer, and faemasks, ect as needed.
- Wash hands frequently: before & after going to the bathroom, eating, touching your face



# DEADLINES

## 4-H Enrollment

You must have been enrolled in your 4-H project by June 1st. This means you have enrolled with your projects selected and paid your enrollment fee.



## Market Livestock Projects

You must have had your market animal tagged by the following dates:

Beef: February 1st

Swine, Goat, Sheep: June 1st



## Entering the Carbon County Fair

Sunday, July 12th @ 10pm

To enter your 4-H project in the county fair you must register at faireentry.com

No late entries will be accepted!



**Notice: PLAN AHEAD! Julie and Emily will not be available to assist you last minute. Make sure that you plan to enter prior to the weekend!**

# Animal Ownership Paperwork



## Market Beef, Swine, Goat, Lamb (not Breeding)

Ear Tag: put in by Fair Board at an official tagging event, they report it to the Ext. Office for you, you DO NOT have to record it in 4HOnline

Beef & Sheep: must have an official change of ownership paper at Fair



## Horse

IDs: on paper this year, contact your horse leader for more info

Safety Certification: meeting with your horse leader, they fill out form, contact horse leader for more info



## Dog

ID: paper form, get from dog leader or Ext Office, return to dog leader or Ext Office

Shot Records: official record from your vet, you can email, fax, mail, or drop them off at the Ext. Office



## Rabbits

Tattoo in the left ear. Use any number you want. Use a sharpie or tattoo gun



## Cats & Poultry

Fair Superintendents may ask you for applicable shot/vaccine records at Fair



**2-1-20**

All Market Beef must be owned by February 1st



**6-1-20**

All Market Sheep, Swine, and Goats must be owned by June 1st



**6-15-20**

All Market Poultry must be owned by June 15th



**6-15-20**

All Cats must be owned by June 15th



**6-15-20**

All Market Rabbits must be owned by June 15th



**7-1-20**

All Dogs must be ID'd with shot records by July 1st



**7-1-20**

All Horses (owned or leased) safety certs are due July 1st



**Questions**

Call the Extension Office 307-328-2642 or email Emily ehaver@uwyo.edu

# SCHEDULE

## Schedule Sunday, July 12 to Monday August 3

Sunday, July 12- All entries due in [fairentry.com](http://fairentry.com) NO LATE ENTRIES!

10:00PM All 4H/FFA entries due in [fairentry.com](http://fairentry.com)  
SATURDAY, July 25  
 7:00 AM Enter Open Class Horse Show  
 8:00 AM Open Class Horse Show—Prompt Beginning  
THURSDAY, July 30  
 8:00 AM 4H Clothing Construction/Style Revue Judging-CC Multi-Plex  
FRIDAY, July 31  
 8:00 AM Dog Show Registration  
 9:00 AM Dog Show—East Lawn  
 5:00 PM Mud Volleyball Tournament

SATURDAY, August 1  
 7:00 AM Lions Club Pancake Breakfast—Jeffrey Center  
 10:00 AM Fair Parade—Downtown  
 1:00-3:00 P.M. Open Class Entries Taken, Exhibit Hall

**Crab Crack**  
**Saturday, August 1**  
**Masonic Temple**

SUNDAY, August 2  
 8:00 AM– 10:00 A.M. Check in Swine—NO SWINE BEFORE 8AM  
 8:00 AM Jr. Horse Mouthing & Check-In  
**10:00-11:00 AM Sheep Check-In/Inspection by Veterinarian**

9:00AM **MANDATORY HORSE SHOW EXHIBITOR MEETING-Arena**  
 Jr. Horse Show—Showmanship, Halter & English Classes, Programmed Ride & Trail, Performance  
 Immediately Following  
 9:00-11:00 AM Judge Misc. 4H, Setup 4H Booths  
 8:00-10:00 AM Enter Open Class Exhibits—Exhibit Building  
 12:00-3:00 PM Judge Open Class Exhibits  
 4:00-7:00 PM Check in Swine  
 6:00 PM Ranch Rodeo Enter at 6, Start at 7  
 6:30 PM Enter Open/Bring 4H Rabbits & Poultry

MONDAY, August 3  
 7:30-9:00 AM Enter Open/Bring 4H Rabbits & Poultry  
 7:30 AM Jr. Horse Mouthing & Check-in  
 8:00-10:00 AM Check in Swine

8:00 AM **MANDATORY HORSE SHOW EXHIBITOR MEETING-Arena**  
 Immediately Following Jr. Horse Show—Timed Events-Barrels & Poles  
**8:00 AM-10:00 AM Sheep check-in/inspection by veterinarian**

8:00 AM-1:00 PM FFA Entries on Grounds  
 9:00 AM-1:00 PM Set-up FFA, Open Class & Commercial Booths  
 9:30 AM Rabbit Show—East Lawn Show Ring

**Energy Day!**  
**Monday, August 3**  
**Noon-4:00 P.M.**  
**Center Parking Lot**

12 NOON Sheep Lead Entries Due at the Fair Office  
 1:00 PM Poultry Show—East Lawn Show Ring  
 1:00 PM Weigh Market Sheep/Goats  
 2 PM-8 PM Exhibit Buildings Open to the Public  
 2:00 PM Judge FFA Exhibits

4:00 –6:00 PM Check in Swine  
 5:00 PM Cat Show—Exhibit Building Demonstration Booth  
 5:00 PM Enter Super Horse Competition—Arena  
 5:30 PM Working Ranch Horse Contest  
 7:00 PM Award Jr. Horse Show Overall Awards—Arena  
 7:00 PM Weigh Market Swine



# Schedule Tuesday, August 4- Thursday August 6

## TUESDAY, August 4

- 10:00 AM-9:00 PM Exhibit Buildings Open to Public
- 8:30 AM Sheep Show—Multi-Plex
- 8:00 AM Cattle Dog Trials
- 1:00 PM Meat Goat & Dairy Goat Show—Multi-Plex
- 12 NOON Enter Pie Contest—Demonstration Booth
- 1:00 P.M. Judge Pie Contest
- 1:00 PM Weigh Market Beef
- 4:00 PM Sheep Lead Contest—East Lawn Show Ring
- 6:00 PM Breeding & Showmanship Swine Show—Carbon County Multi-Plex
- 7:00 PM County Roping Enter at 6, Rope at 7

## WEDNESDAY, August 5

- 10 AM-8 PM Exhibit Buildings Open to Public
- 8:00 AM Market Swine Show—Carbon County Multi-Plex
- 12 NOON Enter Cookie & Cake Contest—Demonstration Booth
- 1:00 PM Judge Cookie & Cake Contest
- 2:00 P.M. Dummy Roping Contest-East Lawn
- 3:00 PM **SWINE, SHEEP & GOAT SALE LINE-UP, STATE FAIR SIGN-UP & CONSIGNMENT/MEDICAL FORMS DUE IN FAIR OFFICE—MANDATORY**
- 3:00 PM Clover Bud Promotion Exhibit Hall Demonstration Booth
- 3:00 CC Project Heifer Judging—Preg. Tests, Interviews, Evaluations
- 4:00 PM Practice for Public Style Revue—CC Multi-Plex
- 5:00 PM Public Style Revue—CC Multi-Plex
- 7:00 PM CC Rodeo, Mutton Bustin' & Wild Pony Races

Wednesday, August 5  
2:00 p.m.  
Tractor Driving Contest—  
Arena

## THURSDAY, August 6

- 10 AM-8 PM Exhibit Buildings Open to Public
- 9:00 AM Beef Show followed by Showmanship—Carbon County Multi-Plex
- 12 NOON Enter Chili Cook-Off—Demonstration Booth
- 1:00 PM Award Program Heifer Project Heifer Awards followed by Breeding Beef Show
- 1:00 P.M. Judge Chili Cook-Off
- 1:00 P.M. 4H Pocket Pet Show—Grassy Area by Fair Office
- 2:00 PM Enter Home Brew Contest
- 2:00 P.M. Dummy Roping Contest-East Lawn
- 3:00 PM Judge Home Brew Contest
- 3:00 PM **BEEF SALE LINE-UP, STATE FAIR SIGN-UP & CONSIGNMENT/MEDICAL FORMS DUE IN FAIR OFFICE—MANDATORY**
- 5:00 P.M. 4H State Fair Exhibitor Meeting
- 6:30 P.M. Dummy Roping Finals—Grandstands Arena
- 7:00 P.M. Carbon County Rodeo, Mutton Bustin' & Wild Pony Races

Thursday  
Tablescaping Entries Only!  
Take Down 4-8 p.m.  
Exhibit Hall

**Schedule Friday, August 7 — Saturday, August 8**

**FRIDAY, August 7**

- 10 AM to 1 PM Exhibit Buildings Open to Public
- 11:00 AM Beef Bills of Sale Due in Fair Office**
- 12 NOON Buyers Luncheon—Carbon County Multi-Plex Sponsored by Rawlins State Bank**
- 1:00 PM Jr. Livestock Sale—Carbon County Multi-Plex
- 1:00 P.M. Release Open Exhibits/Commercial Booths
- 3:00 PM Pack 4H Items for State Fair
- 4:00 PM Release All 4H/FFA Livestock**
- 6:00 PM Release All Other 4H/FFA Exhibits
- 7:00 PM Mini Bulls and Buckers—Rodeo Arena

6:30 PM Demo Derby Pit Crew Meeting, at the Peppermill  
**SATURDAY, August 8**

- 3:00: PM Demolition Derby

# Good Luck



# Participants!

Wyoming 4-H

UW | EXTENSION





# FABRIC & FASHION

## What to Expect & Responsibilities:

- Fabric & Fashion Judging and Style Revue Judging both happen simultaneously
- Whether you are in the Style Review or not, all judging of pieces will be done at the same time so bring all your Fabric & Fashion entries!
- We are trying a new thing this year. The show ring will be set up already and we will be doing judging around it
- Each family will have it's own "home-base" to promote social distancing. Please try to stick to your home base as much as possible
- ATTENTION: On the afternoon of the public style review, fairgrounds gates close at 4PM. Therefore, contestants and audience members need to park OUTSIDE of the fairgrounds and walk in.
- For tips on how to prepare for the Style Review visit the State 4-H Fashion Revue website here. Their evaluation form is the same we use at county fair, so you will know what the judges are looking for.
- Narration Sheets: If you will be participating in the Public Style
- Review, you must fill out a narration sheet giving information about you and
- your outfit to be read whole you are on stage. This sheet is due by email to
- Christy Stocks by Saturday, August
- 3. It is attached to this email for you to fill out
- and email to her.

## What to Bring:

- all your Fabric & Fashion entries
- hangers for each of your items
- styling products: blow dryer, bobby pins, etc

## Where to Go:

- Carbon County Fairgrounds, Multi-Plex

## When You Need to be There:

- Judging: 8AM, Thursday, July 30th
- Public Revue: Practice at 4PM, Show at 5PM

## Consider Entering the Make It With Wool contest on the same day!



Lisa Johnson  
District 9 MIWW Director  
(307) 327-5318  
PO Box 694 Encampment, WY 82325  
johnson7294@yahoo.com

June 22, 2020

I hope you all are having a great summer and starting to work on your wool garments. We have set the date for this year's contest on Thursday July 30th in the Exhibit Hall at the Fairgrounds in Rawlins at 8:00 a.m. 4-H contestants will be put on a schedule to model for the MIWW contest then over to the 4-H judging. All other contestants will model first for the judges, then can go to lunch while the judges critique the construction. The Public Style Revue and awards for all the MIWW contestants will be at 2:30 p.m.

[Entries are due post-marked to Lisa by July 15th](#)

# CARBON COUNTY PUBLIC STYLE REVUE

## NARRATION SHEET

Please return to Christy Stocks by **August 1, 2020** through email: [cstocks57@gmail.com](mailto:cstocks57@gmail.com)

Questions: Christy - 307-380-7170 or Carbon County Extension – 307-328-2642

Write a narration for the outfits you would like to model in the Public Style Revue.

Most stylists prefer narrations to be about 1 minute. Narrations must not be longer than 2 minutes.

The Public Style Revue will be held in the multiplex, at the fairgrounds, on Wednesday, August 7, 2019.

Youth should show up ready to practice by 4 pm. The public style revue begins at 5 pm.

Name: \_\_\_\_\_

Number of outfits to be modeled \_\_\_\_\_ (You may model a total of 3 outfits)

Order of appearance \_\_\_\_\_ (this may be changed)

Please include:

Age, Home Town, Grade in School, Name of School, Parents

Description: (Use description from pattern envelope, describe each piece)

Your interests or hobbies



# DOG

## What to Expect & Responsibilities:

- We will start Agility with the highest level and work our way down.
  - ✓ Level 1 - with a leash
  - ✓ Level 2 - with a leash or tab
  - ✓ Level 3+ - without a leash
- Do not go to the judges with issues, please see Jessica.
- Have your hair up, no hats, no flip-flops, and no high heels.

## What to Bring:

- Comfy clothes and tennis shoes you can run in for agility, business casual clothes, flat collar, choke collar if needed, showmanship/confirmation leash, 6" leash or tab, kennel if you choose, treats, water for your dog, snacks and drinks for yourself, tent or umbrella for shade.

## Where to Go:

- East Lawn by the sheep barn.

## When You Need to be There:

- Friday, July 31: Registration 8:00 am, show starts with Agility at 9:00 am .



# CAT

## What to Expect & Responsibilities:

- You will not be asked for a health paper or proof of vaccination at this show but if your cat acts or looks sick, you may be asked for one or you will be excused.
- Make sure to wear proper showmanship attire, even if you are not in showmanship. A quiet well mannered cat at home can act very differently at a show in a totally different environment. So this is for your protection.

## What to Bring:

- Your cat with claws clipped, in a collar with a leash, in a cat carrier. A soft bristled grooming brush, and a rag, black pants, white long sleeved buttoned downed collared shirt, closed toed shoes.

## Where to Go:

- West end in Exhibit Hall, next to the foyer and restrooms.

## When You Need to be There:

- Be in the Exhibit Hall a 4:45 pm on Monday, August 3rd.



# RABBIT

## What to Expect & Responsibilities:

- **Warning: The Wyoming State Veterinarian has identified Hemorrhagic in Wyoming, this is a highly contagious rabbit disease. We will do everything we can to protect your rabbit but you bring your rabbit to county fair at your own risk.**
- Each rabbit will be inspected for signs of sickness before they check in. If your rabbit shows any signs of sickness, you may be asked to leave the fairgrounds.

## What to Bring:

- A lock for your cage if you'd like, a waterer, a food dish, extra food, a fan, grooming tools,
- Show Clothes: black pants, white button down, closed toed shoes

## Where to Go:

- Rabbit Show will be held under the big white tent east of the Poultry Barn.

## When You Need to be There:

- Check In - Sunday, August 2 from 6:30 - 8:30pm / Monday, August 3 from 7:30 - 9:00am
- Show - Monday, August 3 at 9:30am at the East Lawn Tent.



# POULTRY

## What to Expect & Responsibilities:

- There will be an inspection of each animal before caging.
- The fairgrounds will provide you with a cage.
- Your poultry animals must be owned and in possession by June 15th.
- Two entries limited per class.
- No Rooster can remain on grounds.
- Review page 76 of the fairbook.

## What to Bring:

- A waterer, a feeder, extra feed, things to keep your bird clean, a lock for cage if wanted.
- Show clothes - Black pants, long sleeved white collared shirt, close toed shoes.

## Where to Go:

- Bring your bird to the Poultry Barn east of the Bathrooms for inspection and check in.
- All Poultry Shows will be under the big white tent east of the Poultry Barn.

## When You Need to be There:

- Check In - Sunday, August 2 from 6:30 - 8:30pm / Monday, August 3 from 7:30 - 9:00am
- Show - Monday, August 3 at 1:00pm at the East Lawn Tent.



# HORSE

## What to Expect & Responsibilities:

- Senior classes will go first in each event, they are the ones setting an example.
- At times, both arenas will going at the same time. Pay attention and be on your toes to keep up and keep the day moving forward.
- Review the riding patterns for each class on the Wyoming 4-H website: <http://www.uwyo.edu/4-h/projects/animal-science/horses.html>
- Review the competition guidelines for each class you are entered in, also on the Wyoming 4-H horse page

## What to Bring:

- Grooming supplies, appropriate attire to wear while riding, tack for various events, water bucket for your horse, plenty of water and snacks for you!

## Where to Go:

- Horses - Enter the fairgrounds through the Rodeo Contestants Gate off of Harshman Street and unload your horse into the brand new horse barn! You may park your horse trailer in an out of the way spot near the horse barn.
- Contestants - Meet in the grandstands Sunday morning after unloading your horse.

## When You Need to be There:

- Sunday, August 2nd
- Be at the fairgrounds to settle your horse by 7:00am
- **8:00 am sharp!** - Contestant meeting in the grandstands. Show to start immediately following.



## EQUINE RANCH SKILLS DAY AT COUNTY FAIR!!

*Come one come all!! Youth equine fun day to be hosted **Monday Aug. 3, 2020 8 a.m. at Carbon County Fairgrounds Arena.** You do not need to be enrolled in 4-H or FFA to participate, all you need is a good horse!!*

### Events

*Breakaway Roping*

*Team Sorting*

*Goat Tying*

*Stake Race*

*Cow Work (Boxing)*

**Prizes for top  
Competitors!!**







# GOAT

## What to Expect & Responsibilities:

- Keep your animals fed, watered, and their pens clean.

## What to Bring:

- A fan to keep the air moving around the goats as our barn gets hot, show attire, grooming supplies, water/feed bucket, feed, a halter, wheelbarrow, shovel, rakes.
- Shavings will be provided.

## Where to Go:

- Arrive through the main gate off Harshman St. Unload on the east side of the goat barn

## When You Need to be There:

- We will have 2 check-in times~
  - ✓ Sunday, August 2nd on the east side of the sheep barn from 10:00 to 11:00am OR
  - ✓ Monday, August 3rd on the east side of the sheep barn from 8:00 to 10:00am for check-in.
- Monday at 1:00 in the sheep barn for weigh-in after the sheep
- Tuesday at 1:00 for the goat show in the Multi-Plex
- Animals are released at 4:00 on Friday.
- Your stalls will be clean and your sale animal will be left in that stall unless you are taking them to state fair. (please let Shandi Cary know if you are going to state fair.) You will take your extra goats home unless other arrangements have been made with the superintendents and/or fair board members.
- No goat should remain in the barn after Friday unless other arrangements have been made with the superintendents and/or fair board members.



# SHEEP

## What to Expect & Responsibilities:

- Read the fair book but pay special attention to pages 55, 59, 70 and 71 to know the rules.
- Enter your project by July 12th at 10:00pm on FairEntry.com. No Late Entries will be accepted.
- Get to know the superintendents, Hart and Annie Jordan, for any questions you may have about your project during fair or the weeks leading up to fair.
- Shear your sheep and check for wool fungus a week or two before fair. If you suspect they may have wool fungus, wash them with an antifungal shampoo. (highly recommended!)
- Stall assignments will be located on the east and west sides of the sheep barn. You will be grouped with your chapter or club. It is fun to decorate your area. This year's theme is "Born in a Barn". (Please do not unload until your sheephave been inspected by one of our Carbon County Veterinarian Hospital (CCVH) veterinarians during the specified check-in times on Sunday and Monday morning.)
- All sheep must have their USDA/APHIS Scrapies tag in place.
- The barn will be judged for herdsman ship. This will be awarded to the club or chapter with the cleanest area and best decorations throughout the entire week.
- Keep your stalls clean at all times.
- Keep fresh water in the stalls. You may need to bring some water from home since many lambs do not like the change and refuse to drink. This causes dehydration.



- Another option is to start adding flavoring, such as a light colored Gatorade, in the weeks leading up to fair.
- Feed and exercise daily.
- Check on your lambs throughout the day.
- No drenching. (see the fair book for details about drenching)
- If you are selling a lamb in the Junior Livestock Sale, let Hart or Annie know which animal you will sell, along with their fair ear tag number. (the yellow one) Please have this information to them ASAP but no later than 3:00pm on Wednesday.
- The showman and a parent/guardian will need to sign a consignment form in the fair office in order to sell their animal. You will also need to attach an official title from a Brand Inspector. These are due in the fair office by Wednesday at 3:00pm. These have to be provided in order to sell your lamb.
- Barn closes at 10:00pm every night—no exceptions.

## What to Bring:

- Your lamb that has been slick shorn at least a day or two before coming to fair.
- Blankets must be removed prior to the health inspection by our county vet.
- Halters, muzzles, and blankets. (The muzzles and blankets are optional but highly recommended. Muzzles keep them from eating the bedding as well as grain from another stall, therefore keeping them from getting sick. The blankets keep them cleaner and protects from getting bug bites, etc.)
- A short hose and soap for washing your lamb.
- Clippers and a stand for fitting your lamb.
- Wheelbarrow, shovels, and rakes for cleaning the stalls and the aisle.
- Shavings for the stalls will be provided.
- Show clothes and shoes. Nice, black jeans and a crisp, white button-down collared shirt is recommended but nice jeans and a nice, long sleeved shirt is acceptable. Closed toed boots.

## Where to Go:

- When you arrive, you will unload on the east side of the sheep barn AFTER a CCVH veterinarian has inspected your lambs.
- Weigh-in will be on Monday at 1:00pm in the sheep barn. There is a minimum weight to show your market lamb.
  - ✓ At least 90 pounds for whiteface lambs.
  - ✓ At least 100 pounds for blackface and speckle-faced lambs.
  - ✓ Weight classes will be posted Monday evening on the east and west sides of the sheep barn.
- The show will start at 8:30 in the Multi-Plex. Please know when your lamb will show and be in the holding area outside of the show ring when the class before yours enters the ring. We need to keep the show running smoothly and will not wait if you are not ready to go in the ring when your weight class is called.

## When You Need to be There:

- We will have 2 check-in times~
  - ✓ Sunday, August 2nd on the east side of the sheep barn from 10:00 to 11:00am OR
  - ✓ Monday, August 3rd on the east side of the sheep barn from 8:00 to 10:00am for check-in.
- When you arrive at the fairgrounds, you will keep your lambs in the trailer until a CCVH veterinarian inspects them for wool fungus and USDA/APHIS Scrapies tags.
- Monday at 1:00 in the sheep barn for weigh-in.
- Tuesday at 8:30 for the breeding and market show in the Multi-Plex
- Friday at 1:00pm for the sale in the Multi-Plex. Don't forget to leave a thank you card to your buyer in the fair office before you leave the grounds!
- Animals are released at 4:00 on Friday.
- Your stalls will be clean and your sale animal will be left in that stall unless you are taking them to state fair. (please let Hart or Annie know if you are going to state fair.) You will take your breeding and extra market lambs home unless other arrangements have been made with the superintendents and/or fair board members.
- No sheep should remain in the barn after Friday unless other arrangements have been made with the superintendents and/or fair board members.



# SWINE

## What to Expect & Responsibilities:

- Get to know the superintendents, Robert Espy and Tom Stockwell for any questions you may have about your project during fair or the weeks leading up to fair.
- Stall assignments will be located on the east and west sides as well as in the breezeway of the swine barn. You will be grouped with your chapter or club. It is fun to decorate your area. This year's theme is "Born in a Barn". **Please do not unload until your pigs have been inspected by one of the superintendents.** You can unload on the south side of the barn at the breezeway in the middle of the barn during the check in times.
- All market swine must be tagged.
- The barn will be judged for herdsmanship. This will be awarded to the club or chapter with the cleanest area and best decorations throughout the entire week.
- Keep your stalls clean at all times.
- Water is provided to each pen in the pig barn, if there is an issue with the water let one of the superintendents know and they will get it fixed.
- Feed and exercise your pig daily.
- Check on your pigs throughout the day.
- If you are selling a pig in the Junior Livestock Sale, then a consignment form must be filled out and turned into the fair office. By August 5, 2020 by 3pm.
- The showman and a parent/guardian will need to sign a consignment form in order to sell their animal. These are due in the fair office by Wednesday at 3:00pm. These have to be provided in order to sell your pig.
- There is a minimum weight to show your market pig of 220lbs unless entered in showmanship.

## What to Bring:

- Show stick/whip.
- Your pigs must be washed and ear tags visible.
- A short hose, soap, brush, rags, lotion for washing your swine.
- Clippers for fitting your pig if not done before fair.
- Wheelbarrow, shovels, and rakes for cleaning the stalls and the aisle.
- Shavings for the stalls will be provided.
- Signage with you and your pigs names.
- Show clothes: nice jeans, nice preferably long sleeve, button-up shirt, close toed shoes

## Where to Go:

- When you arrive, you will unload on the south side of the swine barn AFTER one of the superintendents has inspected your pigs.
- **Weigh-in will be on Monday at 7:00pm in the swine barn.**
- The breeding and showmanship show will start at 6pm in the Multi-Plex on Tuesday the 4th. Please know when your pig will show and be in the barn and listening to the show organizers.
- The market show will begin on Wednesday the 5th at 8am.
- Classes will be posted as soon as possible after weigh in.

## When You Need to be There:

- We will have 2 check-in times~
  - ✓ Sunday, August 2nd on the east side of the sheep barn from 8am – 10am and 4pm – 7pm
  - ✓ Monday, August 3rd on the east side of the sheep barn from 8:00 to 10:00am and 4pm -6pm with weigh in to start at 7
- Tuesday at 6pm for the breeding and showmanship show in the multi plex
- Wednesday at 8am for the market show
- Friday at 1pm for the sale in the Multi-Plex. Don't forget to leave a thank you card to your buyer in the fair office before you leave the grounds!
- Animals are released at 4pm on Friday.
- Your stalls will be **clean**, trash taken out, and your sale animal will be left in that stall unless you are taking them to state fair. (please let one of the superintendents know if you are going to state fair.) You will take your breeding and extra market swine home unless other arrangements have been made with the superintendents and/or fair board members.
- No swine should remain in the barn after Friday unless other arrangements have been made with the superintendents and/or fair board members.



# BEEF

## What to Expect & Responsibilities:

- Tip: Clean things as you pack, be organized, and know how to find things easily. Pack your trailer in the order you need to take stuff out. Go set up stalls before bringing cattle in if possible - send a tack trailer and crew ahead. Don't haul cattle in the heat of the day if you can avoid it.
- Make your own beds, dirty shavings dumped outside barn, keep area clean
- We have a lot of animals this year so everyone will need to be mindful of the space you are taking up and keep your area neat and together
- Tie Up/Down Suggestion: plan 4' per calf and bring a normal cattle panel to secure in the front of your stall so you can easily tie them up and down.
- Covering your tie panel with a vinyl tarp helps protect your calf from eating whatever may be in the feed alley and prevents bedding, water, or anything else from getting blown on your calves from your neighbors.
- Fans: when using fans think about where it's blowing dirt and who can hit their head on it (you and your cow). Consider using the fan hanging brackets up front to blow air across the stall from the left side of the cattle (non-show side). If you have the two-piece brackets and want to hang two fans - stand the front one up, let the back one hang.
- If you are selling a steer or heifer in the Junior Livestock Sale, then a consignment form must be filled out and turned into the fair office by August 6, 2020 at 3pm.
- Beef Bills of Sale are due in the Fair Office by 11AM August 9

## What to Bring:

- feed and hay - calculate how much you need, then add some! Running out at showtime is a disaster. Bring the hay they're used to eating if you can.
- feed pans, water buckets, water tubs (for tie out pens) Start using these at home so they're comfortable eating and drinking out of whatever you're bringing to the show. Communal water tubs = gross. Don't share germs. Get a water filter (RV Section at walmart) to filter out chlorine and other things. Some people even start flavoring water at home to be able to add that flavor at the show.
- extension cords, 3 way plugs, generator if allowed, fans, brackets, appropriate nuts, washers, bolts, and tools to tighten them. Wire, pliers, hammer...tools. Zip ties. Nylonstraps with clips.
- hoses, hose nozzles, wash stuff, blowers & hoses, extra clamps, extra water hoseparts
- Poop forks, shovels, metal fork, wheel barrow - all the tools - Mark your stuff. Tape, paint, write your name on everything.
- VET BOX (for kids and calves) - all the basics, bandaids, neosporin, tylenol, bug bite stuff, thera bloat, electrolytes, THERMOMETER, drench gun, any medications you may need for calves
- PAPERWORK - copy of entry forms, registration papers, health papers, brandpapers, show schedule/book, notebook, pens
- Daily care - sheen, combs, brushes, FLY SPRAY, Extra rope halters, NECK TIES
- Show day - PROPERLY FITTING halters, show sticks, harnesses, show attire, Glue, paint, powderful, oil - don't just bank on the old stuff you've drug around for years and have let freeze and get hot. Color match your colored cattle, Breakdown product, good conditioner
- Cooler with drinks, snack box
- Chairs

## Where to Go:

- You may unload where you would like and lead your animal over to the Beef Barn. Unless otherwise specified, all beef events happen in the Multi-Plex.

## When You Need to be There:

- Unload - by 11:00 am on Tuesday, August 4th
- Meeting - 12:00 pm on Tuesday, August 4th.
- Weigh In - 1:00 pm on Tuesday, August 4th.
- Heifer Judging - 3:00 pm on Wednesday, August 5th.
- Beef Show - 9:00 am on Thursday, August 6th.



# STATIC

## What to Expect & Responsibilities:

- Judging will be scheduled by last name. You will be contacted through email about your scheduled time. If your scheduled time does not work, you must see Emily.
- Only 50 people may be in the Exhibit Hall at any time. There will be one entrance and one exit with volunteer stationed at both doors to manage traffic flow. Please try not to show up before your scheduled time as it will create bunching outside.
- There will be directional lines on the floor so all traffic flows counter-clockwise: enter, get judged, check-out, hang in your club booth, exit. If you need to get to a place in the room that is just behind you, please go all the way around. I know it will be inconvenient but if we can all think about other's and follow the small rules, then we all stay safe and still get to come to fair!
- Please **print and fill out the static exhibit cards at home before coming to fair**. We are trying to limit paper passing and communal pen use.
- Please be considerate of the other 4-Hers who still need to get in to see their judges as you are getting your projects judged. Come prepared and answer your judge's questions succinctly.
- Foods & Nutrition Projects will not be tasted by the judges this year. They will appraise your project based on appearance and texture.
- AFTER FAIR: Static Projects can be picked up on Friday, August 7 after 1PM. If Emily is taking it to State Fair for you, please leave it in the Exhibit Hall. Regardless of whether your project is going to State Fair or not, your ribbons need to be picked up from the Exhibit Hall Friday afternoon after 1PM. Any ribbons not picked up will be thrown away.

## What to Bring:

- Food cards and skill cards printed at home and filled out prior to arrival.
- Your projects ready to display.
- Mask & hand sanitizer

## Where to Go:

- You will enter the Exhibit Hall through the double doors on the North side of the building.

## When You Need to be There:

- 4-H Static will happen from 9am - 11am on Sunday, August 2nd. Do not arrive before your scheduled judging time.

# Static Exhibit Ribbons—Explained



The 4-H recognition model is based on awarding youth in 5 different areas: participation, progress toward self-set goals, achievement of standards of excellence, peer competition, and cooperation. Fair is an opportunity for 4-Hers to earn recognition in two of those ways: colored ribbons that compare your projects to standards of excellence, and rosettes that compare your projects to your peers projects.

## Colored Ribbons: The Danish System

After examining the exhibit and interviewing you about your project, the judge will award your project a colored ribbon based on its' quality compared to a perfect standard. How does your exhibit stack up to the standard of excellence for that project?



Excellent—these projects set the standard of excellence or come very close, they will represent our county at State Fair



Very Good—these projects fall just shy of achieving that standard of excellence, a little more work needed to be put in



Good to Fair—these projects are on their way to meeting that standard of excellence but have some work to go



Needs Improvement—these projects will require a lot more learning and work to bring them up to a standard of excellence

## Grand Champion Rosettes



Once ALL exhibits have been judged and awarded a colored ribbon, the Excellent projects are all compared to each other and an Overall Winner is chosen and awarded a multi-colored ribbon as grand champion of that class and age group (Jr, In, Sr)





PLEASE FEEL FREE TO CONTACT  
OUR OFFICE IF YOU DO NOT HAVE  
ACCESS TO PRINT THE PROPER  
FORMS THAT YOU WILL NEED. WE  
CAN PRINT AND MAIL OR PRINT FOR  
PICKUP AT YOUR REQUEST!  
307-328-2642

FOOD SKILL CARD

How is this product nutritious or healthy? If you modified the recipe, what change(s) did you make and how did the change(s) make the product healthier or more nutritious?

Name: \_\_\_\_\_ County: \_\_\_\_\_  
What Skill(s) did you learn while doing this project?  
(Note: All entries must answer this question)

Turn Over

## BAD TECHNIQUES!

### STATE FAIR PICTURES

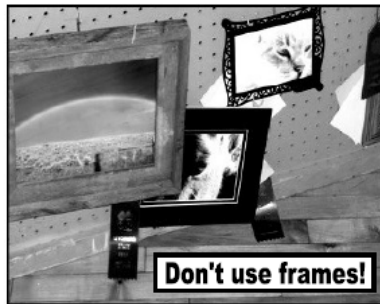

### MAT FRAME or BOARD

Securely attach the photo or drawing to the mat frame or mat board.

Mat Board is a solid piece of thick layered paper pressed into a hard board, they come in many colors and sizes. Mat Frame is the same board with the middle section removed, creating a boarder around the photo or drawing.

PLEASE USE THE FOLLOWING CHART TO SELECT THE SIZE OF YOUR MAT FRAMES:

| IMAGE SIZE | MAT SIZE  |
|------------|-----------|
| 5" x 7"    | 8" x 10"  |
| 8" x 10"   | 11" x 14" |
| 11" x 14"  | 16" x 20" |

### DO NOT USE...

Frames— wooden, plastic, metal or any with stands on the backside of the frame. They are heavy and hard to hang. When they fall, they take out all the pictures below them. You are being judged on the "photo" not on it's mounted presentation.

### DO NOT USE...

The following types of tape to hold the strings on the back of your pictures! Masking tape, duct tape, strapping tape, packaging tape, double-sided tape or blue painters tape. They all weaken due to the humidity and heat of the summer days.

**\*\*Suggested Use: Strong, clear, Scotch Tape completely securing the parameter of the whole photo!**

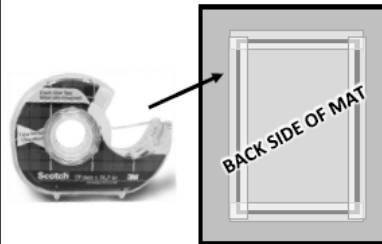

### DO NOT USE...

Weak thin string, yarn, embroidery floss, fishing line, pipe cleaners, coat hangers, ribbon, press-in hooks, or kite string.

**\*\*Suggested Use: Strong thick string or framing wire!**

### YOUR PHOTOS AND DRAWINGS ARE BEING JUDGED, NOT THE METHOD OF DISPLAY!

While a nice frame adds character to your photo or drawing, your entry is only being judged on the picture alone.

Save your frame until you get the entry home and then use it!

### HANGING METHODS:

You can punch holes in the corner of the Mat Board and thread thick strong string or wire through the holes to create a hanger or punch a hole in the center of the frame with a hole big enough for a peg board hook. (hole at least .365")



**NOTE: PEG BOARD HOOKS ARE USED AT COUNTY AND STATE FAIR! Keep that in mind when putting hangers on your pictures.**

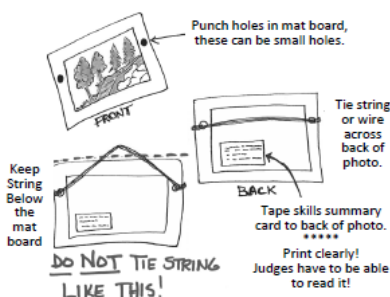

# PHOTOGRAPHY & VISUAL ARTS



## PREFERRED METHODS FOR DISPLAYING PHOTOS AND DRAWINGS AT FAIR

### ADDITIONAL HANGING METHODS:

You can also use solid Mat Board or Foamboard to mount your photos or drawings. Make sure your photos or drawings are affixed to the mounting board properly!

**DO NOT USE DOUBLE SIDED TAPE!!!** (The heat of the summer causes it to fail!)

**\*\*\* Suggestion: Please use double sided FOAM TAPE!**

It has very strong adhesive and can be purchased at your local craft stores or hardware stores.

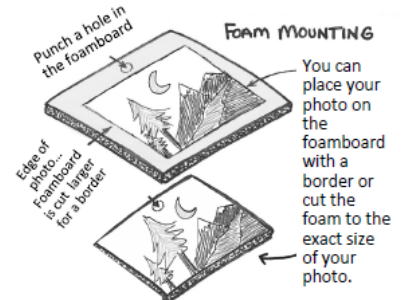

Optional: You can buy Hang Tabs online at Uline, Ebay or Amazon, etc.

Suggested size: 7/8" X 1.25"

Hang Tabs - 7/8 x 1 1/2", Round



# Carbon County 4-H Fair Guide 2020

Issued in furtherance of extension work, acts of May 8 and June 30, 1914, in cooperation with the U.S. Department of Agriculture. Bret Hess, interim dean and director, College of Agriculture and Natural Resources, University of Wyoming Extension, University of Wyoming, Laramie, Wyoming 82071.

The University is committed to equal opportunity for all persons in all facets of the University's operations. All qualified applicants for employment and educational programs, benefits, and services will be considered without regard to race, color, religion, sex, national origin, disability or protected veteran status or any other characteristic protected by law and University policy.

## Contact Us!!

### Carbon County

### Extension: 4-H

PO BOX 280

215 W. Buffalo St.

RM 393

Rawlins, Wyoming 82301

(307) 328-2642

ehaver@uwyo.edu

Visit us on the web at:

<https://wyoextension.org/carboncounty/4h-youth-development/>

Facebook:

Carbon County 4-H

Carbon County Extension  
PO Box 280  
215 W. Buffalo St., RM 393  
Rawlins, Wyoming 82301